

# Virgin Falls Tennessee State Natural Area

- Parking
- Trailhead
- Campsite
- Trail
- Trail Waypoint
- Trail Mileage

Virgin Falls Trail Mileage		
section miles	total miles	waypoint location
0.00	0.00	Trailhead at Scotts Gulf Road
0.45	0.45	Cross Big Branch (seasonal)
0.80	1.25	Cross Big Branch (on rocks)
0.10	1.35	Descend to Big Branch Falls
0.15	1.50	Cross Big Laurel Creek (wire rigged to assist)
0.15	1.65	Overlook Junction
0.65	2.30	Big Laurel Falls
1.10	3.40	Virgin Falls Loop Trail Junction (going right on loop)
0.30	3.70	Sheep Cave Junction
0.075	3.775	Cave (total one way distance to the cave, .15 total)
0.55	4.25	Virgin Falls
0.35	4.75	Trail climbs a ridge
0.20	4.80	Return to the Loop Trail Junction

**Directions to Virgin Falls**  
 From Hwy 111 in Sparta, Tn  
 Take Hwy 70 East toward Crossville  
 After about 11 miles, turn right (south) on Eastland Rd (sign at the intersection)  
 At 6 miles, turn right on Scotts Gulf Rd (sign at the intersection)  
 Trailhead is 3 miles on the right

**For Emergencies - dial 911**

For more information about Virgin Falls State Natural Area please call the Betty Dunn Nature Center (423) 881-5708



NAD27 CONUS Datum, Universal Transverse Mercator Zone 16

cloudhiking.com  
all rights reserved

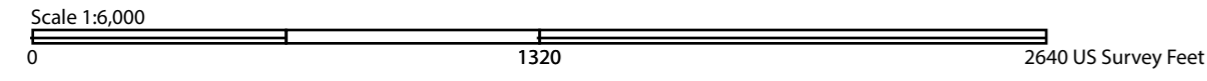

On 02/05/2012 magnetic declination is -4.4° changing by -0.09° per year

