

Standing Stone State Park

1674 Standing Stone State Park Hwy
Hilham, TN 38568

Park Office - 931-823-6347

- State Park Boundary
- State Forest Boundary

- | | | | |
|--|-----------------|--|-------------------|
| | Park Office | | Rest Rooms |
| | Parking Area | | Picnic Area |
| | Recreation Hall | | Campground |
| | Trailhead | | Boat House |
| | Boat Rentals | | Cabins and Lodges |
| | Waypoints | | Park Building |
| | Mileage | | Overlook |
| | Lake Trail | | Other Park Trails |

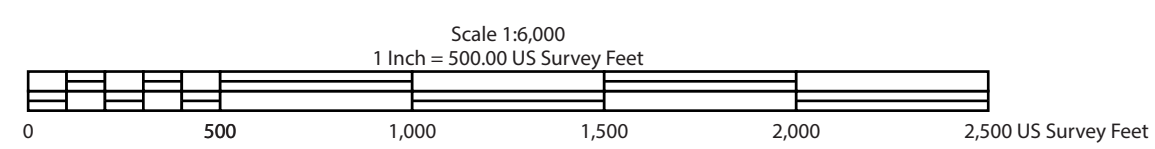

NAD27 CONUS Datum, Universal Transverse Mercator Zone 16

On 01/06/2013 the magnetic declination is -4.5° changing by -0.09° per year

The Lake Trail circles Standingstone Lake in 4.70 miles. The Lake Trail is moderate in grade. Additional information is available at the Park Office. Connector trails lead from the Park Office, Cabins, and Recreation Hall to the Lake.

Please Practice Minimum Impact Usage



cloudhiking.com
all rights reserved